



All COB Meeting

FALL 2022

David Meinert, Dean

August 19, 2022

Missouri State
UNIVERSITY



Special Guests



President
Clif Smart



Executive Vice President
Zora Mulligan

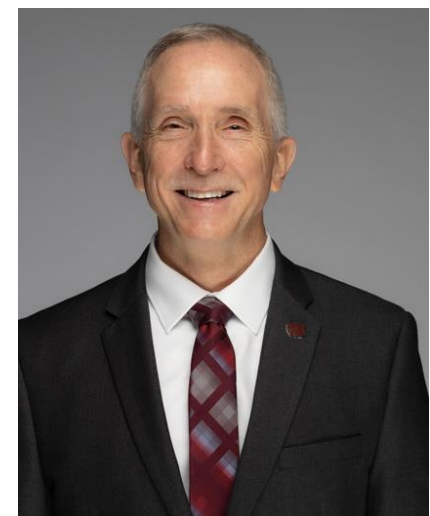

Interim Provost
John Jasinski

Welcome New Colleagues

School of Accountancy

- **Mollie Adams, Ph.D., Virginia Tech University**
Assistant Professor



- **Julie Ravenscraft, Ph.D., Oklahoma State University**
Assistant Professor





Welcome New Colleagues

Finance and Risk Management

- **Tony Na'ayem, JD, University of Tulsa**
Instructor of Business Law



- **Xibei (Michael) Zheng, Ph.D., Texas Tech University**
Assistant Professor of Finance





Welcome New Colleagues

Marketing

- **John Galvan, Ph.D., University of Mississippi**
Assistant Professor
Sales

- **Haiying Yang, Ph.D., Syracuse University**
Assistant Professor
Supply Chain, Logistics, and Operations Management





Welcome New Colleagues

Management Department

- **Azadeh Sabz, Ph.D., University of Houston**
Assistant Professor
Strategic Management





Welcome New Colleagues

Technology and Construction Management

- **JaLynn, Hill, MS, University of Arkansas**
Instructor
Construction Management

- **Dustin Steiro, MS, Missouri State University**
Clinical Assistant Professor
Construction Management





New Staff

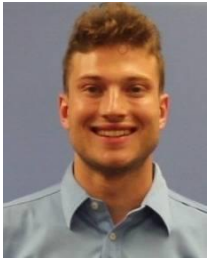

John Bogue, MBA, Missouri State University
Graduate Programs Advisor

Enrollment & Budgets

- Recruitment
- Retention



Enrollment by Department

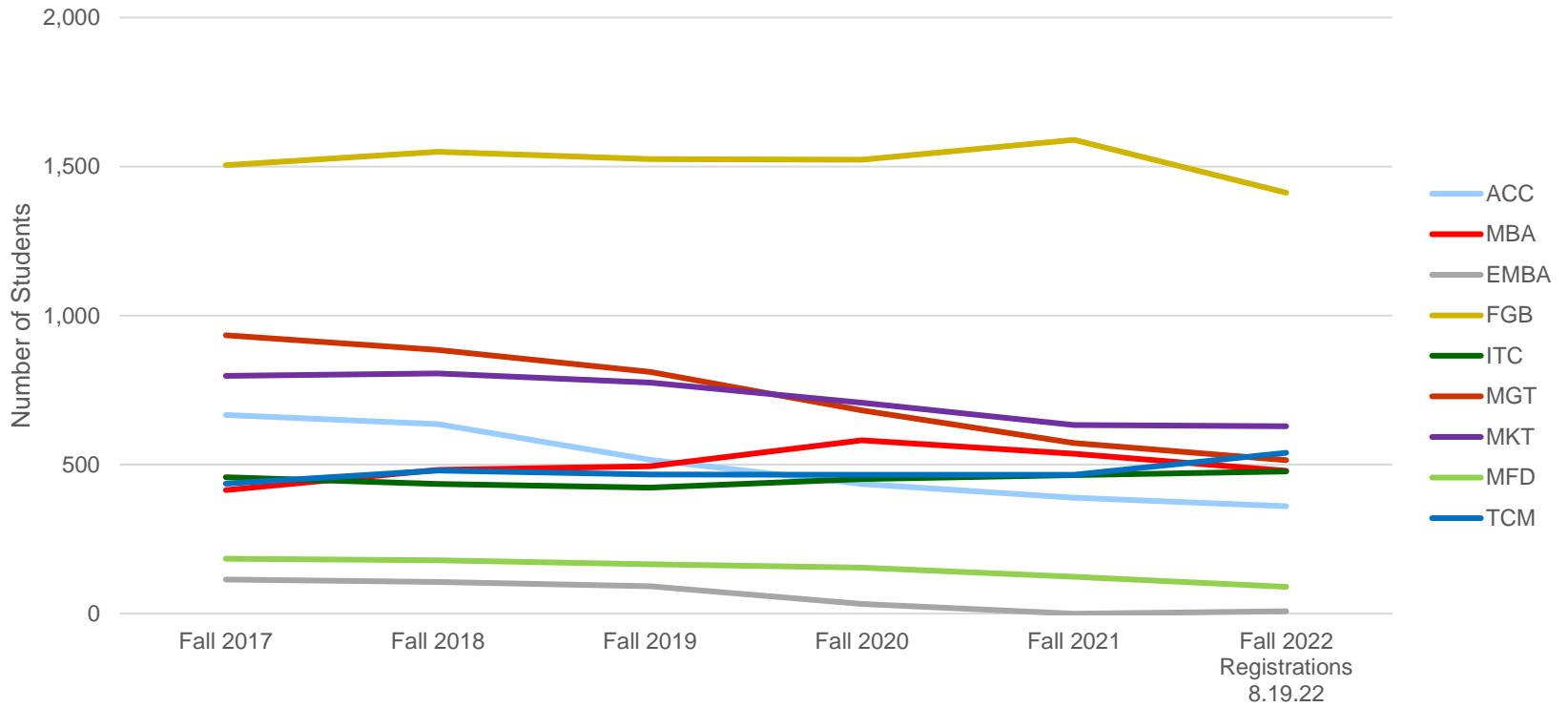



SCH Production by Department

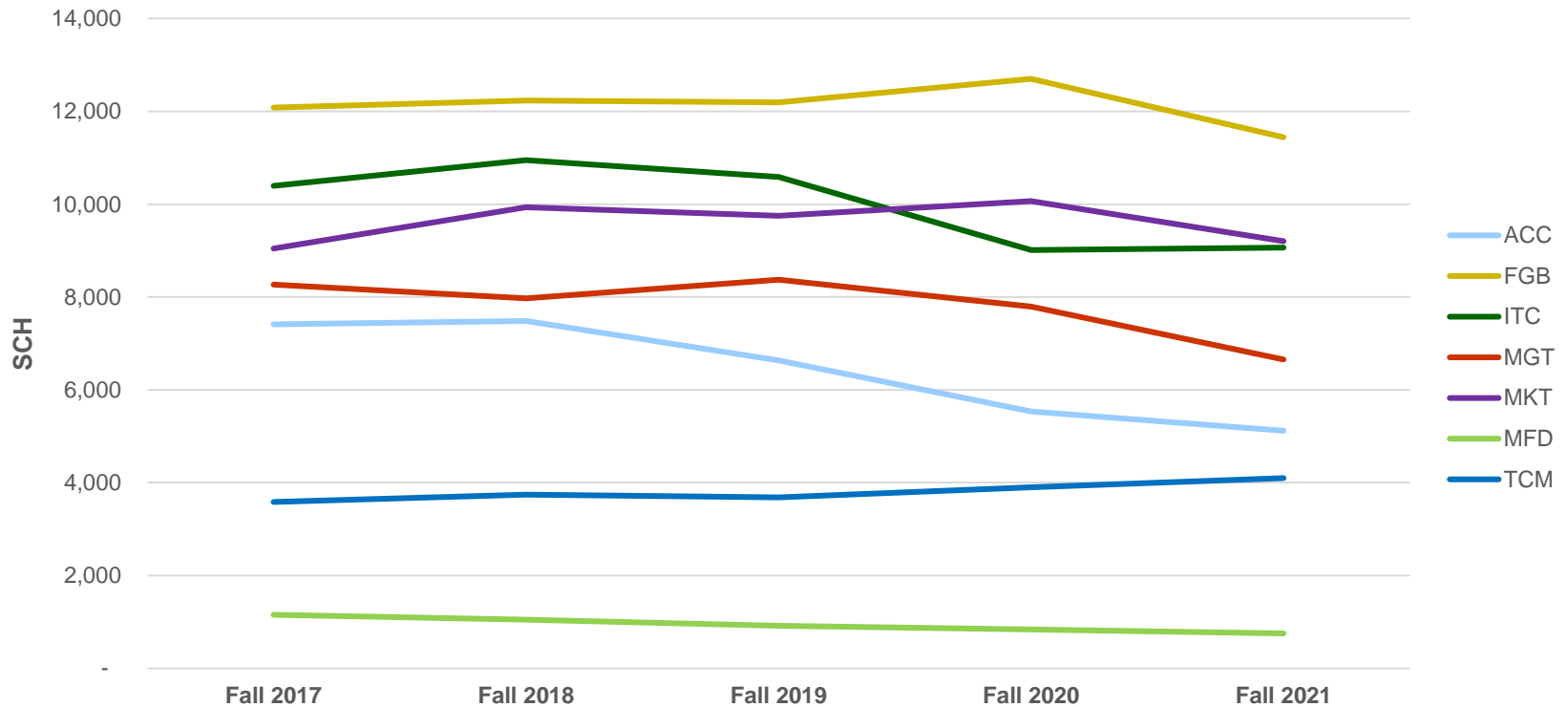

Recruitment

- **Campus Recruiting Events**
 - Fall and Spring Showcases
 - Admitted Student Monday & VIP Transfer Day
 - Summer Visit Day
 - Majors Fair
 - COB Graduate Open Houses (Fall and Spring)
- **Campus and College Visits (In-Person and Virtual)**
- **Print & Email Campaigns to Prospective Students**
- **25 HS College Fairs for FA22 (KC,STL,SGF, SWMO, and many more)**
- **Attend Events**
 - Build My Future (SGF and STL) and iBuild Showcase and DECA (KC)
- **Influence the Influencers**
 - Missouri School Counselors Association Conference
 - Missouri Business Educators Association
- **Host Events on Campus**
 - State and Regional FBLA Conferences & DECA Regional Conference
- **Digital Marketing**
- **Community College Visits**
- **Corporate Outreach (e.g., Amazon Distribution Center, BassPro, CoxHealth, and Mercy)**



Focus on Yield

- Handwritten notes sent to all admits
- MSU COB T-Shirt offered to all admits
- Drip email campaign via CRM for admitted students
- Digital marketing targeting admitted students
- COB invitations to visit campus (e.g., Admitted Student Monday)



Retention

- Inspire
- Engage
- Guide
- Support, Encourage, and Motivate

“People don’t care how much you know until they know how much you care.”

Theodore Roosevelt



Success Stories

AD Team

INSTRUCTOR/ADVISOR – SAMANTHA FRANCKA



Congratulations to Ad Team members and advisor Samantha Francka, for being one of three teams invited to the Department of Homeland Security Headquarters in Washington, D.C. in June to compete in the final round of a nationwide campaign on countering targeted violence and domestic terrorism. The team placed second in the competition and received a \$3,000 award.

FBLA- PBL National Competition

FACULTY ADVISOR – COURTNEY PHAM

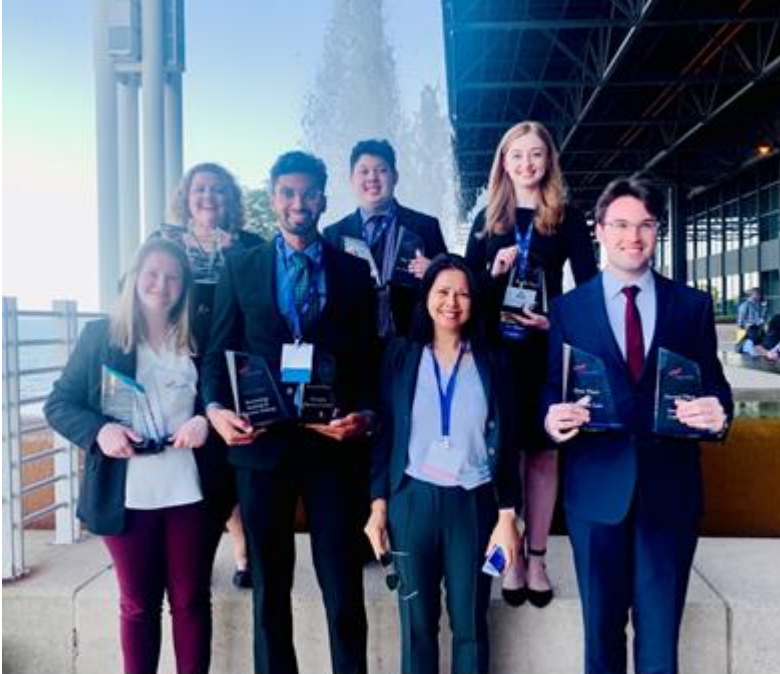

- Accounting Analysis & Decision Making: 1st place
- Business Law: 1st place
- Cost Accounting: 4th place
- Emerging Business Issues: 2nd place
- Human Resources Management: 2nd place
- Information Management: 7th place
- Insurance Concepts: 2nd place
- Justice Administration: 3rd Place, 6th Place
- Marketing Analysis and Decision Making: 4th place
- Project Management: 2nd Place

Congratulations to FBLA-PBL members and faculty advisor Courtney Pham, who took home 11 awards, including two first place prizes, at the National Leadership Conference in Chicago in June. Students competed against 762 students and 139 chapters from 50 different states.



ACCE Accreditation

AMERICAN COUNCIL FOR CONSTRUCTION EDUCATION

- Construction Management Program received six-year reaccreditation





ABET ETAC Accreditation

DECISION NOTIFICATION BY AUGUST 31

- Peer review identified no deficiencies, weaknesses or concerns



Help Us Build Your Brand

PROMOTING COB SUCCESS STORIES

- Share student, student org, staff, faculty and alumni success stories with Sean Barnhill
- See Inside COB for a link to submit information and photos

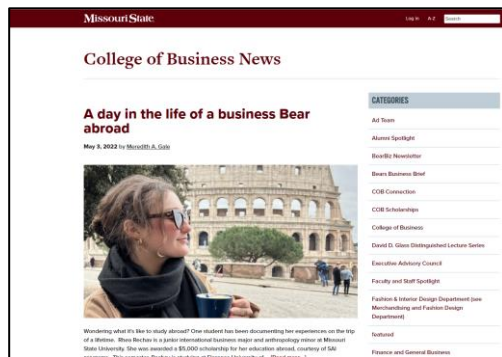

Fall 2022 COB Career Fairs

Missouri State
COLLEGE of BUSINESS

HIRE BUSINESS BEARS!

SCHOOL OF ACCOUNTANCY CAREER FAIR

COLLEGE OF BUSINESS CAREER FAIR

WEDNESDAY, SEPTEMBER 7, 2022

12:00 pm – 3:00 pm
University Plaza Hotel

TUESDAY, SEPTEMBER 13, 2022

10:00 am – 2:00 pm
Springfield Expo Center

business.missouristate.edu/fairs

32 Organizations

127 Organizations



Missouri State
UNIVERSITY

| COB Placement Rate | | | | |
|--------------------|-----------|-----------|-----------|------------------------------|
| 2017-2018 | 2018-2019 | 2019-2020 | 2020-2021 | 2021-2022 |
| 85% | 91% | 88% | 94% | Data Available December 2022 |

ALL COB FA22



COB Career Fairs

FACULTY ASSISTANCE

- Promote via Bb Announcement (provided in upcoming **INSIDE COB**)
- Encourage student participation
- Remind students to complete the virtual “Prepare for the Fair” Workshop
- Increase participation by canceling classes
 - **SOA Career Fair – Wednesday (9/7)**
 - All SOA courses with start times between 11:00 AM and 2:59 PM are cancelled
 - **COB Career Fair – Tuesday (9/13)**
 - All COB courses, except ACC, with start times between 9:30 AM and 1:59 PM are cancelled

COB Resume Cafe

COLLEGE OF BUSINESS

RESUMÉ CAFE

Want your resumé reviewed by an employer or Career Center staff member over a cup of coffee?

Bring your resumé to the second floor of the Glass Hall atrium (in front of the Career Center) to one of the sessions below!

WEDNESDAY, AUGUST 31

11:00 A.M. - 2:00 P.M.

+

TUESDAY, SEPTEMBER 6

11:00 A.M. - 2:00 P.M.

No appointment needed,
feel free to drop in.

Log into your **Handshake**
account to view employers
attending.

Career Center
MISSOURI STATE UNIVERSITY

Carrington Hall 309 | Glass Hall 276 • careercenter.missouristate.edu • 417-836-5636





Personnel Updates

Colleagues in New Roles

Information Technology and Cybersecurity

- **Rebekah Austin, D.B.A., Creighton University**
Assistant Professor
- **Xiang (Sean) Guo, Ph.D., University of Mississippi**
Interim Department Head and Assistant Professor
- **Karen Eisman, MPS, Missouri State University**
Instructor



Colleagues in New Roles

Management Department

- **Pouya Derayati, Ph.D., University of Miami**
Assistant Professor
Strategic Management



Technology and Construction Management

- **Richard Gebken, Ph.D., University of Texas at Austin**
Department Head and Associate Professor



Colleagues in New Roles

- **Finance and Risk Management (FRM)
& Information Technology and Cybersecurity (ITC)**
 - **Tabby Henderson**
Academic Administrative Assistant II





Tenure and/or Promotion

CONGRATULATIONS TO OUR COLLEAGUES

Promotion



**Puneet Prakash (FRM)
Promotion to Professor**



**Phil Rothschild (MGT)
Promotion to Professor**

Tenure & Promotion



Josh Coleman (MKT)
Tenure and Promotion to Associate Professor



Ben Goss (MGT)
Tenure and Promotion to Associate Professor

III Promotion



Radika Kaula (ITC)
Promotion to Senior Instructor



David Hammons (MKT)
Promotion to Senior Instructor



Carly Pierson (MKT)
Promotion to Senior Instructor



Forthcoming Retirement

AUGUST 1989 – DECEMBER 2022



Ed Chang
Professor
FGB\FRM



Technology & Building Updates

KENT RAGAN, ASSOCIATE DEAN



Glass Hall

BUILDING ACCESS

- Building Hours
 - Monday -Thursday, 7:30 am to 9:00 pm
 - Friday, 7:30 am to 6:00 pm
 - Closed weekends and University holidays
- If you ever see something amiss in the building, contact University Safety – (417) 836-5509
- BearPass access 24x7 Access issues – contact Janet Davis



Custodial Services for Offices

- Normal Custodial Service - 1x per week - empty waste containers
- Faculty and Staff can opt-out of custodial services
 - Request is for one year, August 1, 2022 – July 31, 2023
Custodial Services will place a sticker on the office door frame
See INSIDE COB on 8/22 for opt-out [link](#)
 - Requestor must maintain own space and empty waste/recycle containers
 - If the opt-out sticker is missing, a [work request](#) should be entered and/or Work Management contacted
 - If there is an urgent need that requires Custodial attention, a [work request](#) should be entered and/or [Work Management](#) contacted.



Building Issues:

- Trash/Recycling
 - Break it down! Hammer time!
 - Flatten boxes!!!
 - Small number of books at a time!
 - Bag shredded paper!
 - Bag trash before placing in gray cart.
- Your help will be greatly appreciated:
 - Report any issues to your departmental office
 - HVAC
 - Lights
 - Supplies, missing chairs, etc.

Recycling / Trash Czar May Surface at Any Time





Building Projects

- Entrepreneurship Labs - completed
 - Glass 117, 118, and 119
 - Laser engraver arriving soon
- Classroom lighting updates this summer (five) - completed
- Glass 343/344 remodeling - completed
- Glass 350 remodeled FA22 and ready for SP23



Transforming Our Learning Space

MCDONALD STUDENT ENTREPRENEURSHIP LAB



GLASS 117



GLASS 118



GLASS 119



Bigger and Bolder Project AY22/23

- Repurpose\Renovate Glass 229 Open-Access Lab
 - Labs for HID, MFD, and SOA (136 total stations)
 - HID sample library, storage, and work room
 - Display windows for HID and MFD
- Relocate PCOB Academic Units to Glass Hall
 - **NOTE: Open-Access Lab is now in Glass 436**
Please share with students

Glass 229 (former open computer lab)

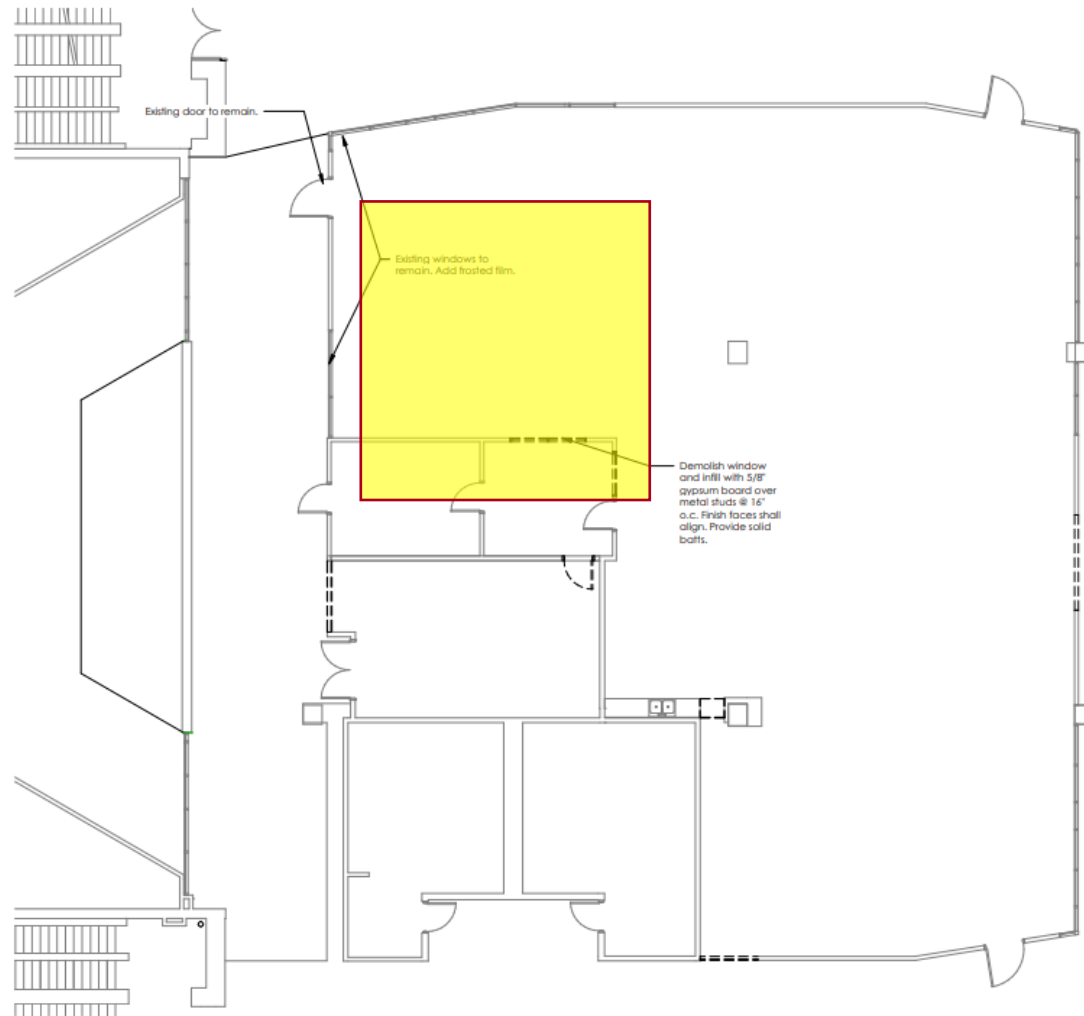

Glass 229 – COB Labs

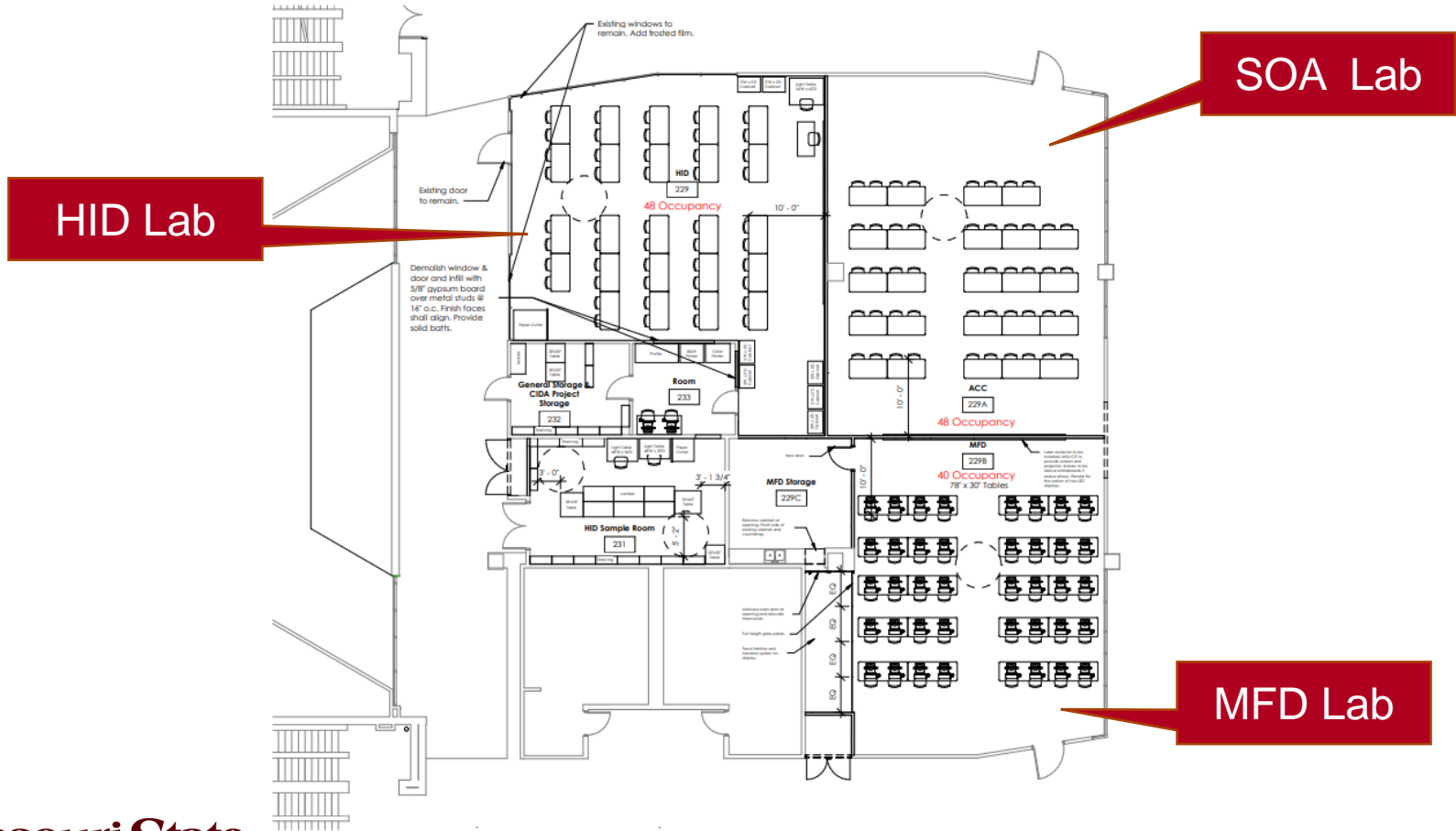

Student Computers and Printer

GLA436 - MONDAY-FRIDAY 8 AM – 5 PM



Education Abroad

2022 PROGRAMS

- Spring Break: Ireland (Michelle Hulett, n = 8) – SP22 semester
- May/June: Italy, Croatia, Montenegro (Marciann Patton, n = 10) – SP22 semester
- August: U.K., France, Belgium, Netherlands (Kent Ragan, n = 14) – SU22 semester





Education Abroad (Cont'd)

PLANNED PROGRAMS

- January 2023: Egypt / Turkey (Kent Ragan, n = 10) – FA22
- Spring Break 2023: Ireland (Michelle Hulett) – SP23
- May/June 2023: Scotland (Jason DeBode) - SP23
- May/June 2023: Greece/Turkey (Marciann Patton) - SP23
- May/June 2023: UK/France/Ireland (Michael Merrigan) – SP23
- January 2024: Peru (Jason DeBode) – FA23
- **2024 or beyond:**
 - Somewhere Interesting and Educational
 - **YOU!!!**



Education Abroad (Cont'd)

COB MENTOR PROGRAM FOR FACULTY AND ADVISORS

- Contact Michelle Hulett and/or Kent Ragan if you are interested
- Lead time can be 18-24 months
- Significant interest among mentees for 2023!

Program Proposal Deadlines – Some indication of future lead-times:
Proposal Deadlines for March – August 2023 Programs
Sept. 1, 2022 (July 30 to have a table at the Sept. 29 Education Abroad Fair)



CHINA CAMPUS

- Fall 2022 – Record Enrollment
 - 150 +/- Seniors
 - 230 +/- Juniors
- 150 May graduates
- Freshman and sophomore numbers forthcoming, but program is surely at an all-time high!!!



EMBA Program

- **China EMBA Program**

- January 2023 Unlikely
 - Many Chinese campuses are online, so recruiting is difficult

- **Egypt EMBA Program**

- Joint Online Program with Arab Academy of Science, Technology and Maritime Transport (AASTMT)
- COB delivers 18 cr. hrs. - ACC 711, FIN 780, MGT 764, MGT 767, MKT 772, QBA 775
- AASTMT delivers 16 credit hours
- Working toward Summer/Fall 2023 start



AACSB, FQ Forms and February 1st

LIBBY ROZELL, ASSOCIATE DEAN



AACSB CONTINUOUS IMPROVEMENT REVIEW (CIR) TIMELINE

- 2017-2018 Internal Annual Report
- 2018-2019 Internal Annual Report
- 2019-2020 Internal Annual Report
- 2020-2021 Internal Annual Report
- 2021-2022 Self-Study Year
- **2022-2023 Preparation & Submission of CIR Report**
- **CIR Peer Review Team Visit – October 2- 4**





Degrees Awarded

LIVES CHANGED ...

Exhibit B
 Number of Degrees Awarded in the Business Unit
 College of Business: FY2017– FY2021

| Department | FY2017 | FY2018 | FY2019 | FY2020 | FY2021 |
|--|--------------|--------------|--------------|--------------|--------------|
| UNDERGRADUATE | | | | | |
| Accounting, School of | 141 | 144 | 149 | 129 | 85 |
| Finance and General Business | 285 | 302 | 336 | 361 | 328 |
| Information Technology and Cybersecurity | 88 | 99 | 103 | 104 | 93 |
| Management | 194 | 201 | 216 | 210 | 191 |
| Marketing | 182 | 194 | 184 | 257 | 232 |
| Undergraduate Total | 890 | 940 | 988 | 1,061 | 929 |
| GRADUATE | | | | | |
| Master of Accountancy | 36 | 24 | 40 | 51 | 34 |
| Master of Business Administration | 319 | 287 | 250 | 286 | 332 |
| MS in Cybersecurity | 6 | 12 | 16 | 21 | 18 |
| Master of Health Administration | 9 | 20 | 24 | 37 | 30 |
| Graduate Total | 370 | 343 | 330 | 395 | 414 |
| GRAND TOTAL | 1,260 | 1,283 | 1,318 | 1,456 | 1,343 |

Intellectual Contributions

Exhibit S

AACSB Table 8-1: Summary of Intellectual Contributions by Discipline
July 1, 2017 – June 30, 2022

| | Portfolio of Intellectual Contributions | | | Types of Intellectual Contributions | | | Percentages of Faculty Producing ICs | |
|------------------------|---|--|-----------------------------------|-------------------------------------|---|-----------|--|---|
| | Basic or Discovery Scholarship | Applied or Integration/Application Scholarship | Teaching and Learning Scholarship | Peer-reviewed journal articles | Additional peer-reviewed intellectual contributions | Other ICs | Percent of Participating Faculty Producing ICs | Percent of total Full Time Equivalent (FTE) faculty producing ICs |
| Accounting | 15.5 | 47 | 27 | 32.5 | 50 | 7 | 73.3% | 67.1% |
| Business Law | 0 | 7 | 1 | 3 | 2 | 3 | 66.7% | 55.0% |
| Finance | 57.78 | 10 | 16.67 | 33.78 | 41.67 | 9 | 84.6% | 76.8% |
| Information Technology | 63 | 10 | 9.33 | 58.17 | 7.17 | 17 | 73.3% | 59.9% |
| Management | 37.22 | 24 | 10 | 38.22 | 25 | 8 | 83.3% | 78.0% |
| Marketing | 58.83 | 11 | 6 | 39.5 | 31.33 | 5 | 88.2% | 84.9% |
| Statistics | 8.67 | 0 | 0 | 6.83 | 0.83 | 1 | 80.0% | 74.3% |
| Total | 241 | 109 | 70 | 212 | 158 | 50 | 80.2% | 72.7% |



Percentage of PRJs Listed in ABDC and ABS

Exhibit T

Percentage of Peer Reviewed Journals Listed in ABDC and ABS by Department
2017-2021

| Department | ABDC | ABS |
|------------------------|------------|------------|
| Accounting | 61% | 45% |
| Finance | 51% | 34% |
| Information Technology | 27% | 22% |
| Management | 30% | 26% |
| Marketing | 55% | 34% |
| COB TOTAL | 42% | 31% |

Australian Business Deans Council (ABDC)

Chartered Association of Business Schools Academic Journal Guide (ABS)



Digital Measures for Annual Reviews and T&P Dossiers

- Infrastructure and integration challenges
- Update teaching and service activities



New FQ Forms

- Easier to navigate
- Office 365 form



Important Deadline – February 1

- FQ forms
- Summer research grants
- Annual faculty evaluations
- Award applications



University Safety

BE PREPARED

- Add (417) 836-5509 to your contacts
- Manage your Missouri State Alert preferences



Research Grants

- Faculty Research Grants (up to \$7,500)

Submit proposal to the Graduate College by October 1st or February 1st

- Summer Faculty Fellowship (\$6,000)

Submit proposal to the Graduate College by October

- Faculty Research Opportunities can be found

at <https://www.missouristate.edu/provost/orientation/fundingsupport.htm>

See *Inside COB* for more details

Public Affairs Conference



- September 20-22, 2022
- Mix of free in-person speakers and live virtual panel sessions
- Conference Schedule:
<https://publicaffairs.missouristate.edu/2022/schedule.aspx>



Public Affairs Award in Research

- Recognize COB contributions to MSU's Public Affairs Mission
- Recognize outstanding COB scholarly activities related to Public Affairs
- Encourage faculty to explore research opportunities in their respective disciplines with a Public Affairs Dimension

See [Faculty and Staff Awards and Guidelines – 2022-2023](#) on the COB Website under Faculty Resources and Policies to learn more about COB Awards.

Executive-in-Residence

ROBERT “ROB” FULP

- MSU Alum – finance and banking
- 40+ years in the banking sector
- Last 10 years as CEO of Springfield First Community Bank
- Office in Glass 400
- Supporting COB, eFactory, JVIC and the MSU Foundation
- Assisting COB with:
 - Outreach to the Business Community
 - Career Readiness and Mentoring
 - Alumni/Supporter Relations





COB Tutoring Lab

- Drop in hours
- Virtual tutoring by appointments
- Will open after Labor Day



BAC ADVISING

UNDERGRADUATE STUDENTS

- Requests to Add closed sections
 - Direct students to contact their assigned advisor
- Issues with schedule/modality changes
 - Direct students to contact their assigned advisor



Department Shoutouts

- SOA
- FRM
- ITC
- MGT
- MKT
- MFD
- TCM
- MBA – GRAD PROGRAMS
- BAC



Q&A



**THANK YOU FOR ALL YOU DO TO SUPPORT
OUR STUDENTS AND BUILD THE COB BRAND!**

HAVE A GREAT FALL SEMESTER!





MAKE YOUR MISSOURI STATEMENT™

Missouri State.
UNIVERSITY